

Instructions for making draw string uniform bags

Fabric required: Cotton or pay cotton - must be colour fast, washable and clean. Old sheets, duvet covers, and pillowcases are perfect!

1. Cut 2 rectangles of fabric 40cm X 45cm (minimum) but can be slightly different to fit fabric.
2. Overlock or pink all four sides to stop fraying.
3. Place right sides together. Using a 1.5cm seam allowance, stitch around 3 sides leaving the 40cm top open.

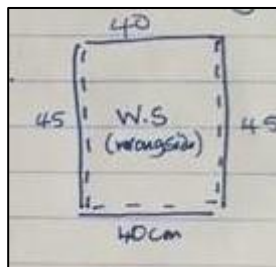

4. Turn right sides out.
5. Fold open top edge over by about 3 cm to form a hem/channel for the tape/ribbon.

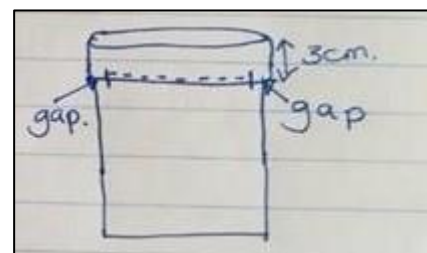

6. Stitch as close to the edge as possible, leaving a gap at each side to insert ties.
Remember to back-tack!

7. Cut 2 lengths of ribbon/tape long enough to go around the top of the bag. Using a safety pin to thread, start at 1 side and thread all the way around until it comes out at the start again. Repeat and thread from the other side (see internal view). Tie the ends together and pull- **It should close!**

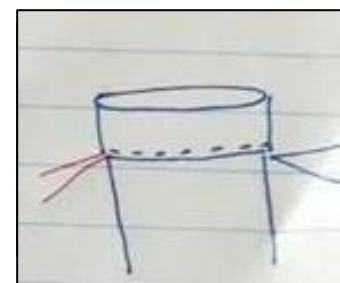

8. Take a picture to show us your wonderful bag and let us know where you have chosen to send it: Northampton General Hospital, Kettering General Hospital or Northamptonshire Healthcare Foundation Trust. 😊. Let us know at enquiries@healthwatchnorthamptonshire.co.uk

Thank you to Jan Rogers for the instructions.